

PROPOSED LAYOUT FOR TEXTILE PARK AT JASPUR

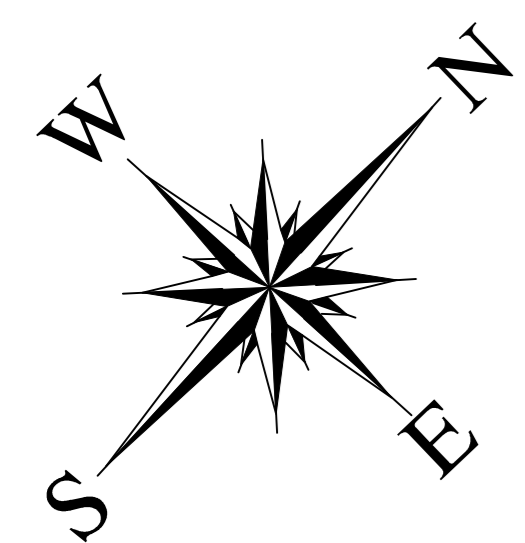
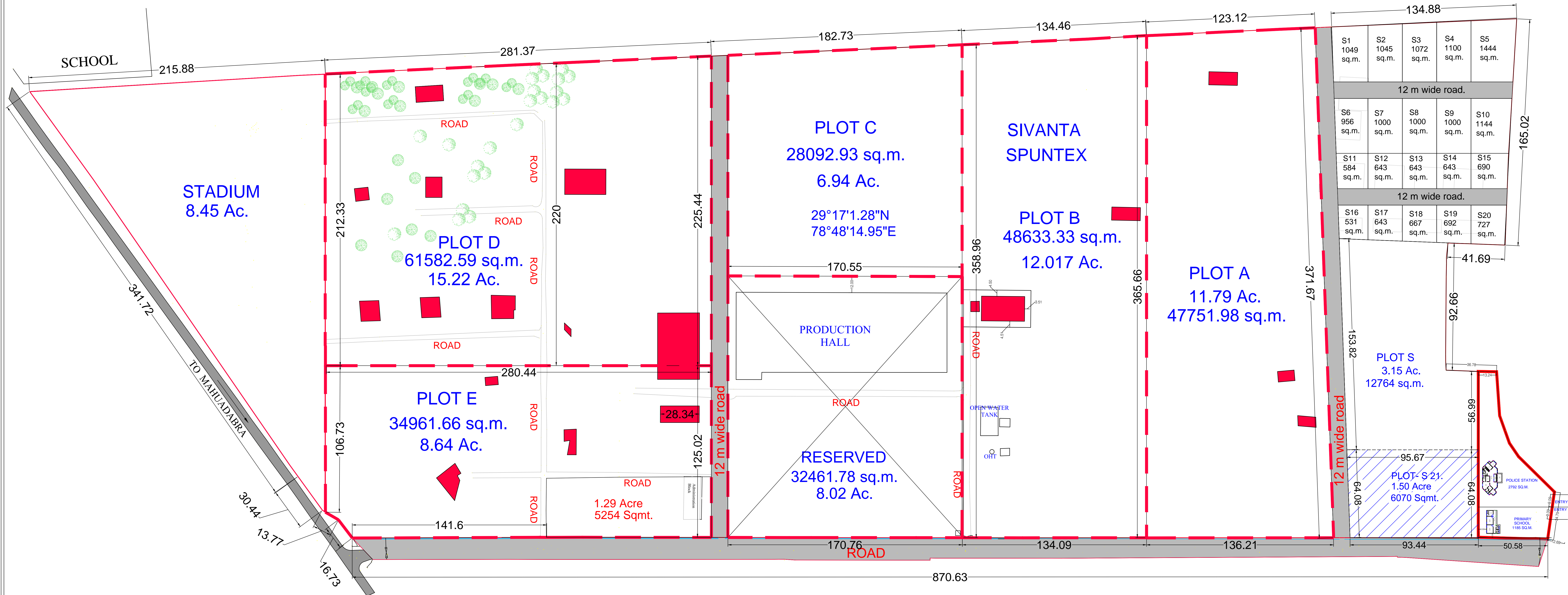

**EXISTING SPINNING MILL
U.P.S.T.C. JASPUR
UTTARAKHAND**

TOTAL LAND AREA- 83.36 Ac.

LEGEND:

- EXISTING BUILD.
- ORCHARD
- ROAD AREA
- NALA

NORTH

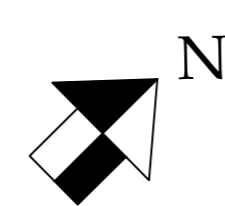

SCALE

1: 1500

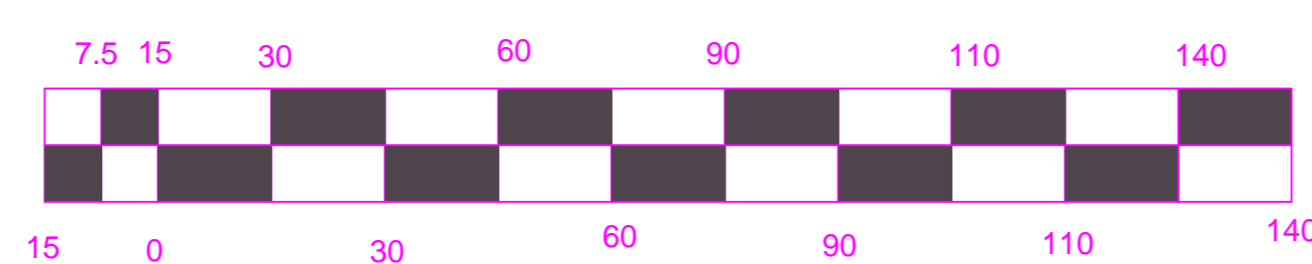

STATE INFRASTRUCTURE & INDUSTRIAL
DEVELOPMENT CORPORATION OF UTTARAKHAND
LTD.



29, IIE, SAHASTRADHARA ROAD
(I.T. PARK) , DEHRADUN-248001
Ph. No. - 0135-2708100, 2607292
Website :- www.sidcul.com

Architect Planner

DGM (Commercial)

Director (Planning)

General Manager

MD SIDCUL

**ALLOTABLE ARE FOR TEXTILE = 64.53 AC.
ROAD AREA = 6.19 AC.**